

6 Section Detail - Section Detail - Roof Mounted Mechanical Equipment Curb
1 1/2"=1'-0"

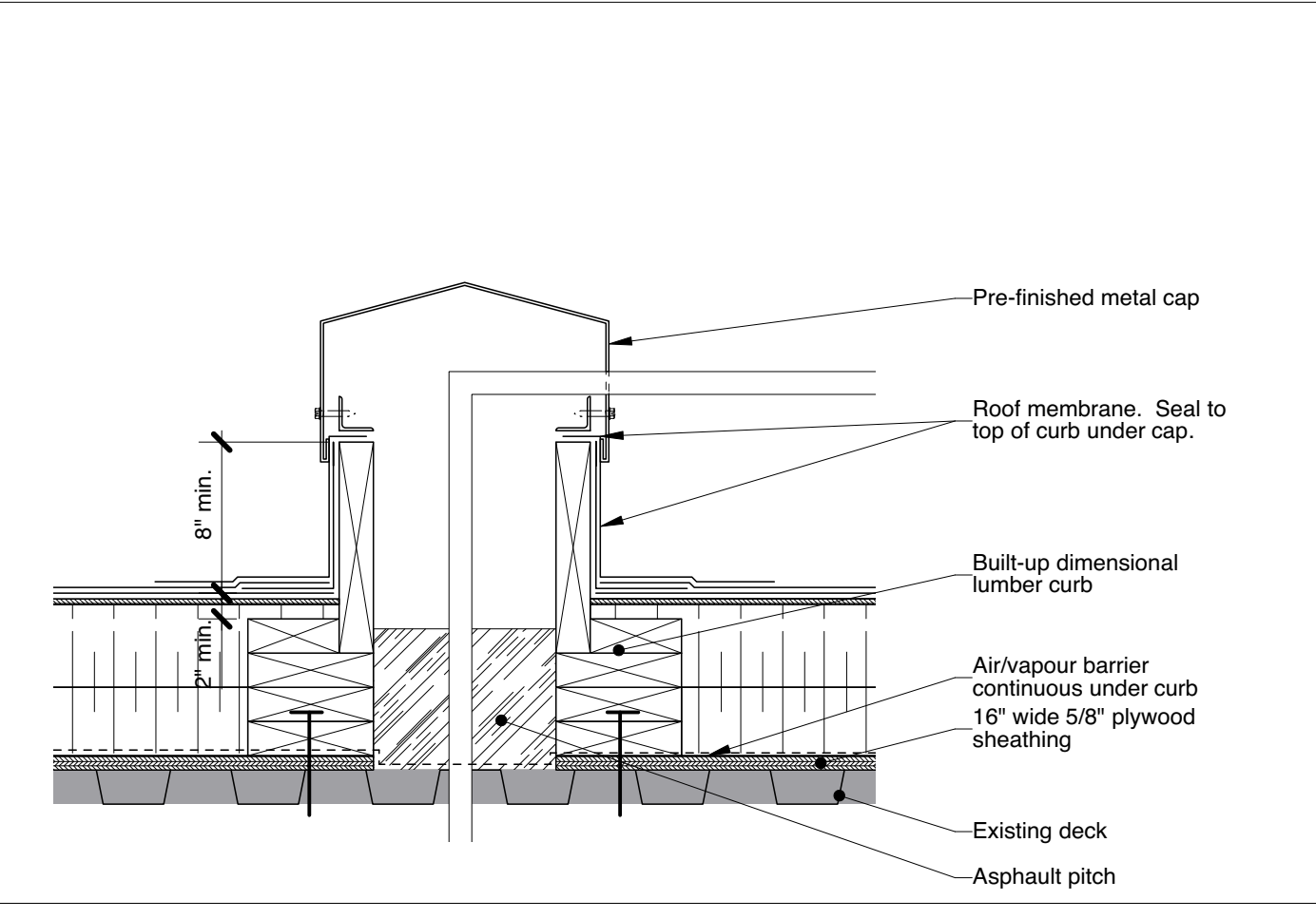

5 Section Detail - Pitch Box
1 1/2"=1'-0"

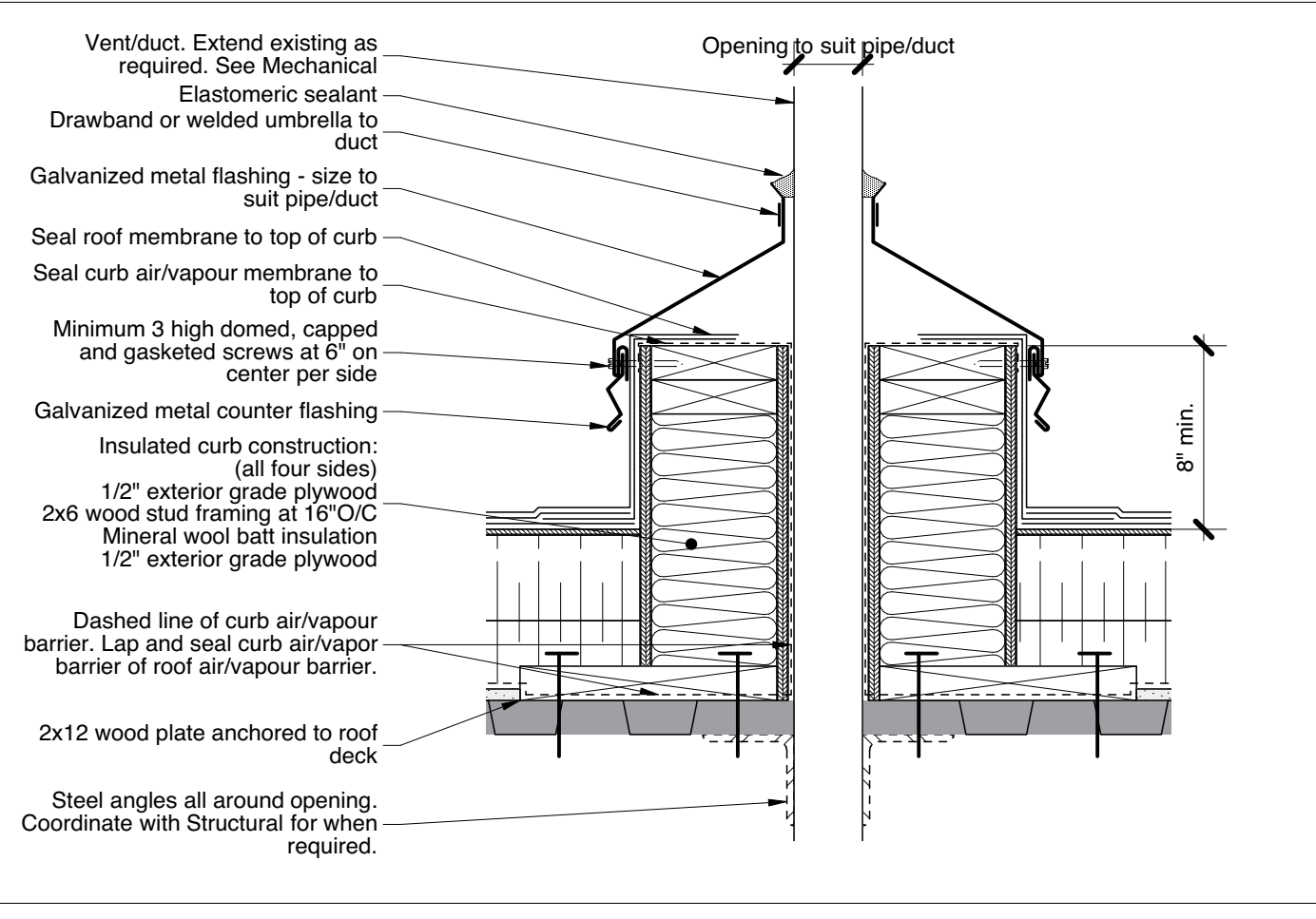

4 Section Detail - Pipe/Duct Penetration Through Roof
1 1/2"=1'-0"

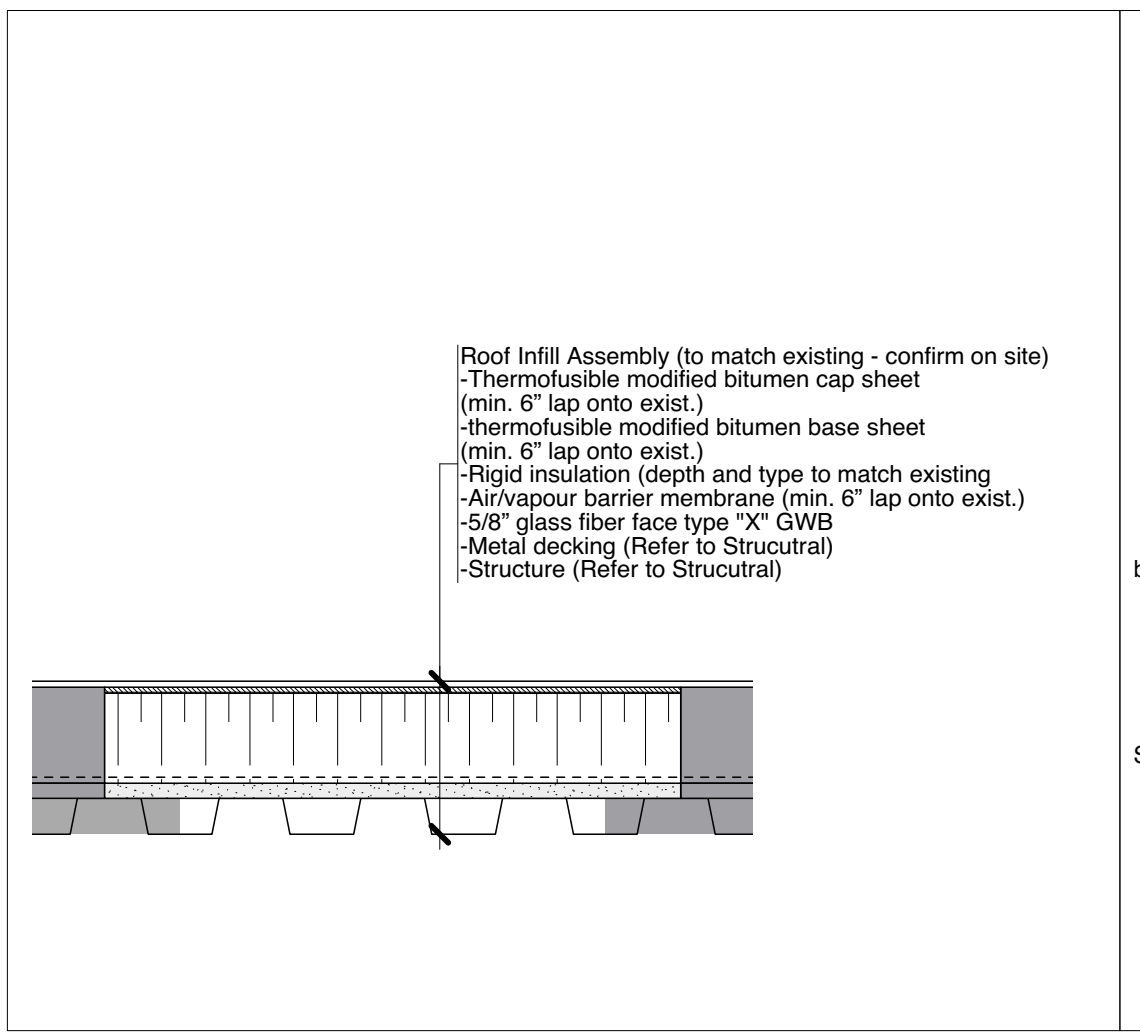

7 Section Detail - Existing Roof Infill
1 1/2"=1'-0"

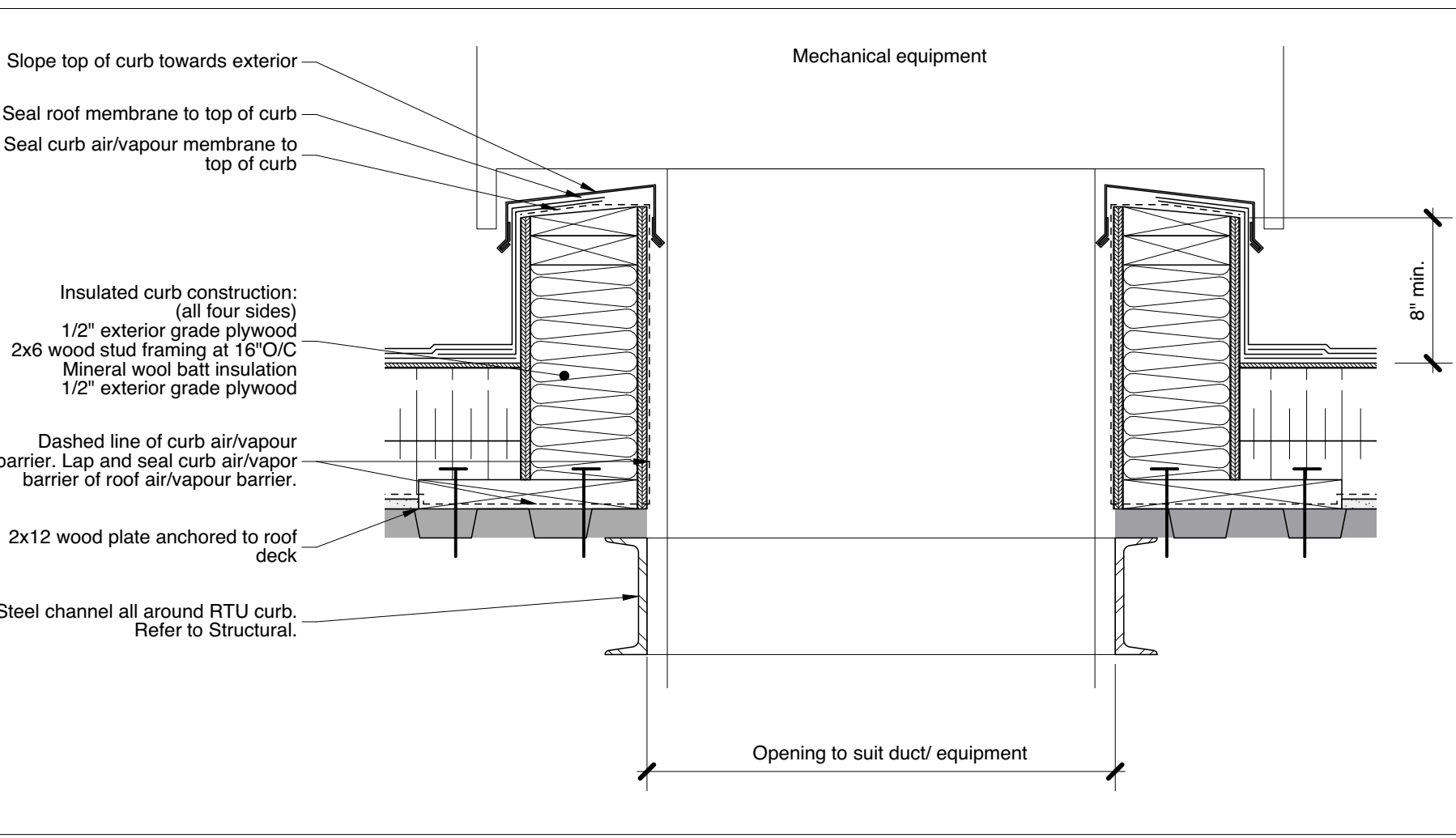

3 Section Detail - Duct Penetration Through Roof
1 1/2"=1'-0"

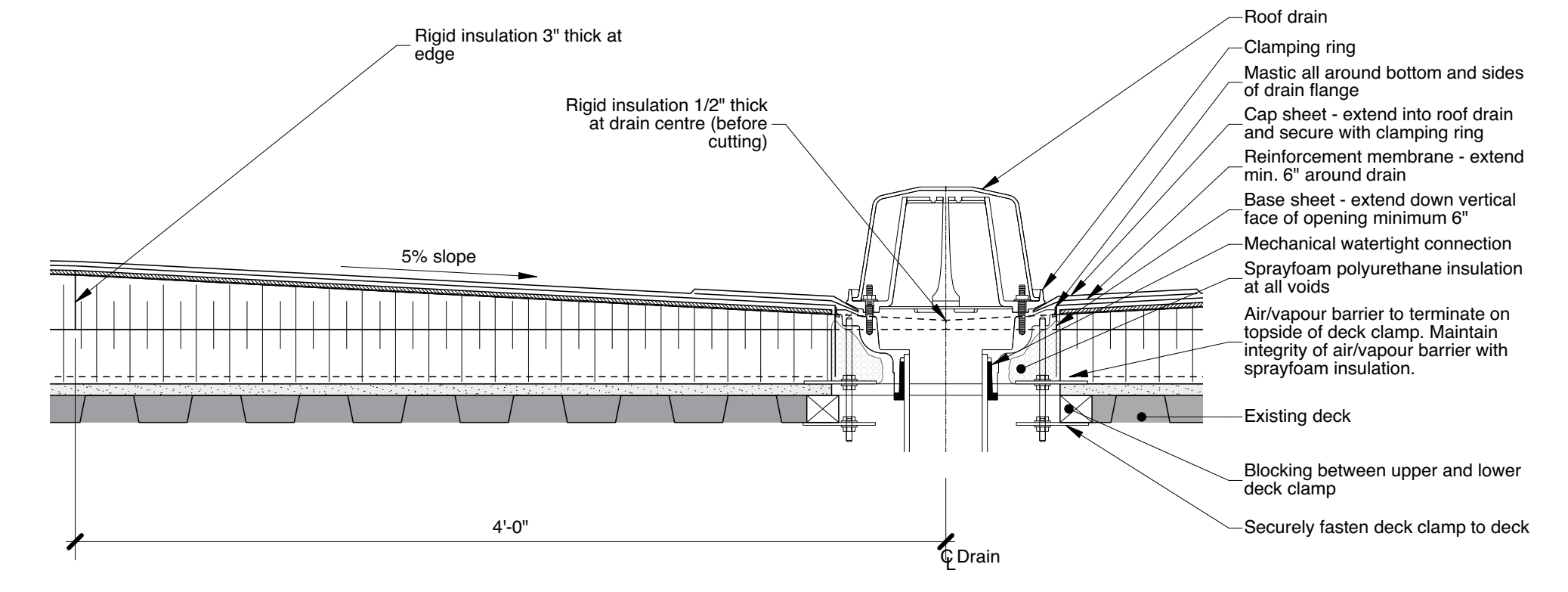

2 Section Detail - Roof Drain
1 1/2"=1'-0"

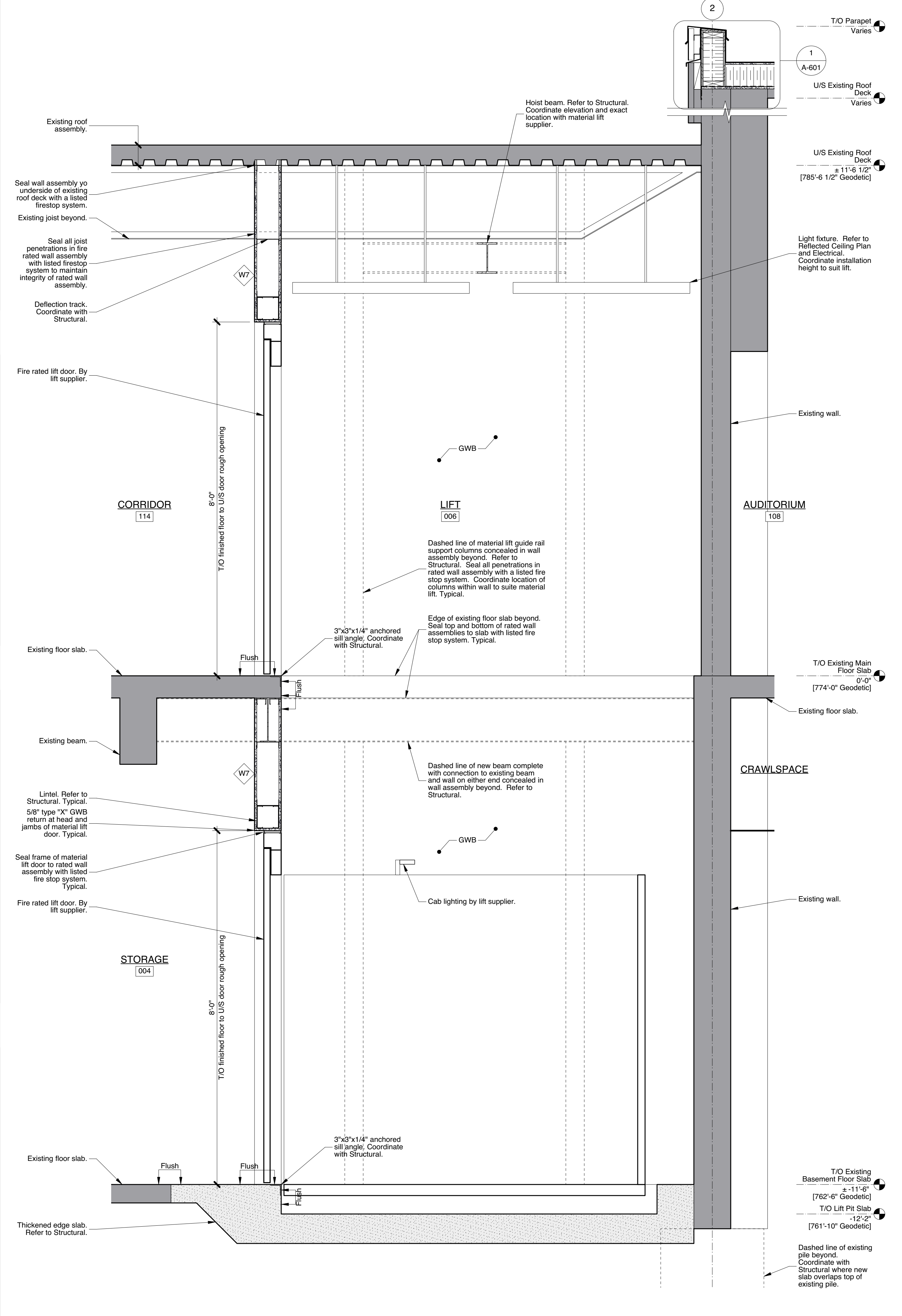

1 Wall Section - Material Lift
3/4"=1'-0"

Light fixture. Refer to Reflected Ceiling Plan and Electrical. Coordinate installation height to suit lift.

Existing wall.

AUDITORIUM
108

T/O Existing Main Floor Slab
0'-0"
[774'-0" Geodetic]

Existing floor slab.

CRAWLSPACE

Existing wall.

T/O Existing Basement Floor Slab
±11'-6"
[762'-6" Geodetic]
T/O Lift Pit Slab
-12'-2"
[761'-10" Geodetic]

Dashed line of existing pile beyond. Coordinate with Structural where new slab overlaps top of existing pile.



This drawing must not be scaled. The contractors shall verify all dimensions and other data on site prior to commencement of work. Discrepancies, errors, and omissions are to be reported to Public City Architecture Inc. prior to proceeding with the Work.
Drawings and specifications as instruments of service are the property of Public City Architecture Inc.; the copyright in the same being reserved.
No reproduction or revision to these drawings may be made without the permission of Public City Architecture Inc., and when made, must bear their name. All prints to be returned to Public City Architecture Inc. upon request.

Project
St. James Civic Centre
Phase 2 Building Systems
Upgrades
Drawing

Drawn By
MP
Scale
As Noted
Date
2019.07.01

Reviewed By
PS
Tender No.
1176-2019
Drawing No.
A-501